

Spring Pump Head

UC15



Product Introduction

UC15 spring pump head is widely used for medical dialysis equipment. Transparent protective cover, can observe the working situation anytime; uncover signal output, stop working when uncover to ensure safety; Elastic roller assembly, running smoothly; manual lever help install the tube, and can finish liquid circulation when power down unexpectedly; support stepper motor ,DC motor, AC motor and sevro motor.

Typical Application

| Medical dialysis equipment.

Dimension Drawing (Unit: mm)

Supporting instrument 57 stepper motor

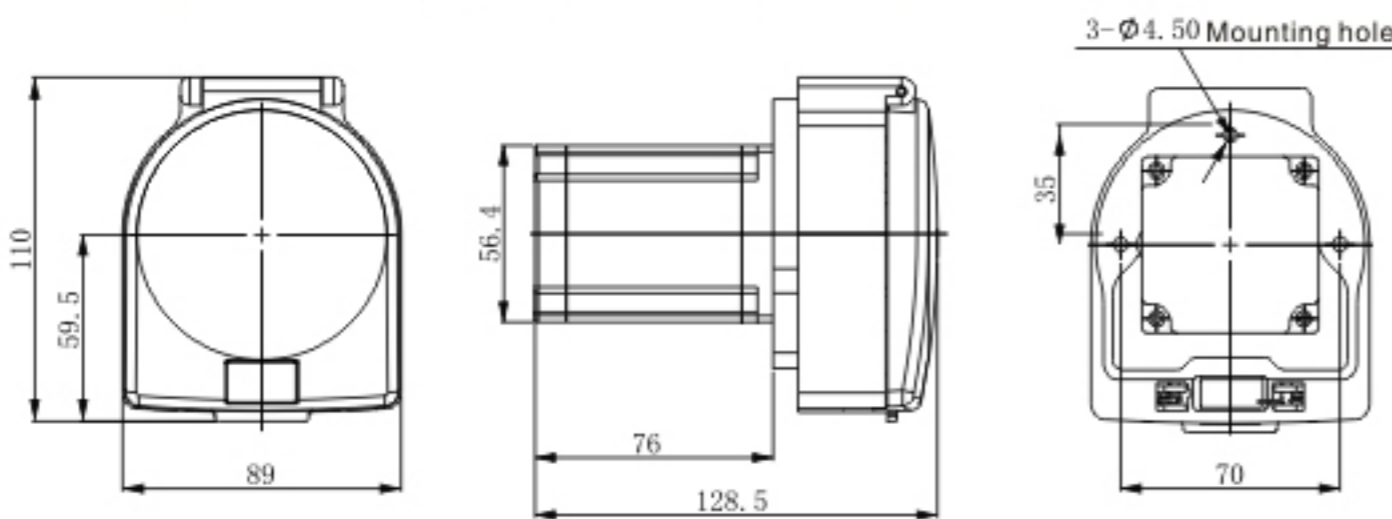

Tubing Installation Procedure

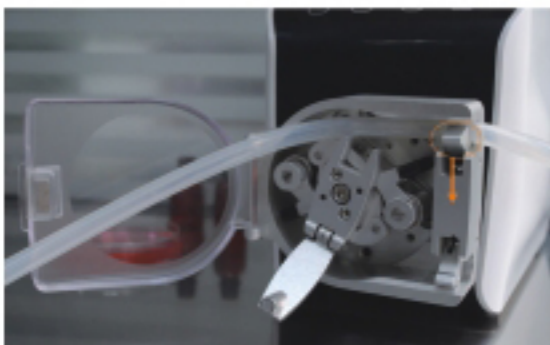

1. Press the pipe clamp, put the tube into the U shaped groove.

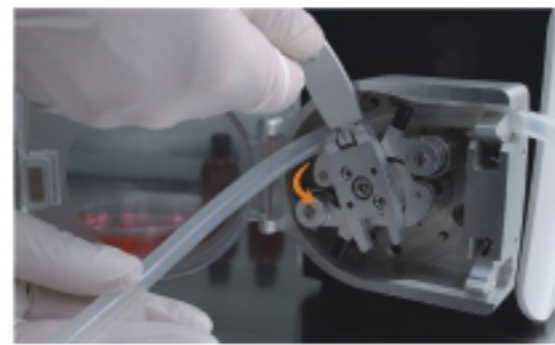

2. Put the tube between the two guide posts. Hold the spanner, rotate the wheel body.



3. Press the pipe clamp, put the tube into the U shaped groove.



4. Installation is finished.

Technical Specifications

Model	Housing Material		Rollers assemble construction	Tubing		Speed Range (rpm)	Flow Rate (mL/min)	Weight(kg)
	Base	Protecting cover		Size	ID×Wall(mm)			
UC15	PSF	PC	spring-like structure	19 [#]	2.4×1.6	0.1-350	0.0875~306	1.37
				16 [#]	3.1×1.6		0.1525~533	
				25 [#]	4.8×1.6		0.3537~1237	
				17 [#]	6.4×1.6		0.6488~2270	
				18 [#]	7.9×1.6		0.7625~2668	

